

TV Wall Mount

Fixed

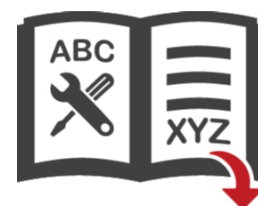

Download Assembly Instructions with Text

For more information: [barkanmounts.com](https://www.barkanmounts.com)

If you are satisfied with the product, please give us a 5 stars ★★★★★ rating on the website you bought it from. If you are not satisfied please contact us at <https://www.barkanmounts.com/support> and we will solve the problem for you.

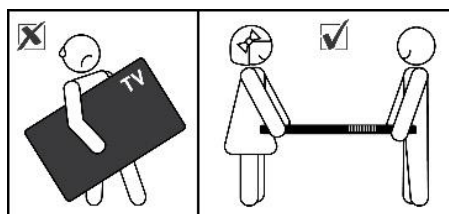
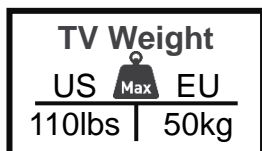

⚠ CAUTION This Mount is intended for use only with the maximum weight indicated. Using heavier products might cause injury.

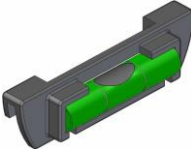
A  x1		B  x2	
Z4  x4	Z7  x8	Z8  x1	
W1  x4	W2  x4	W3  x4	



#	M	L mm	L inch	pcs
Z1	6	16	5/8	4
Z2	6	25	1	4
Z3	4	20	3/4	4
Z5	8	25	1	4
Z6	8	45	1 3/4	4

Required Tools

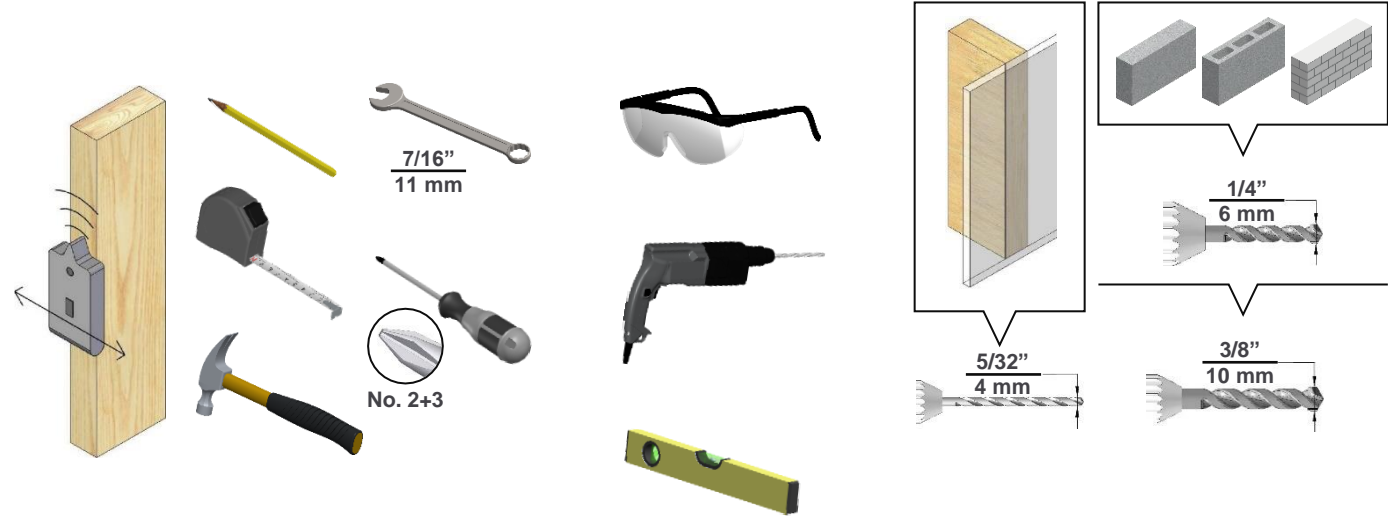

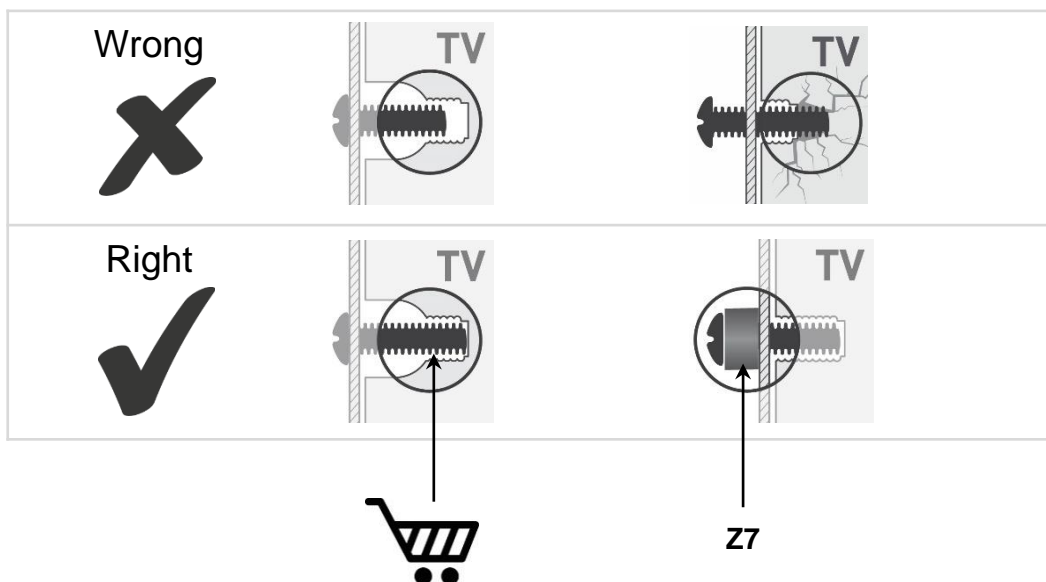

1

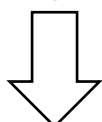
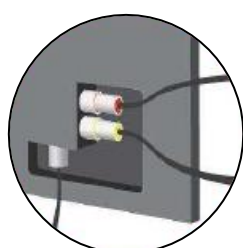

1a

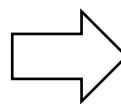
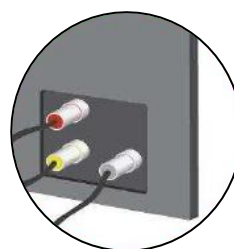

1b

Page 4

1a

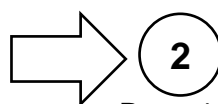
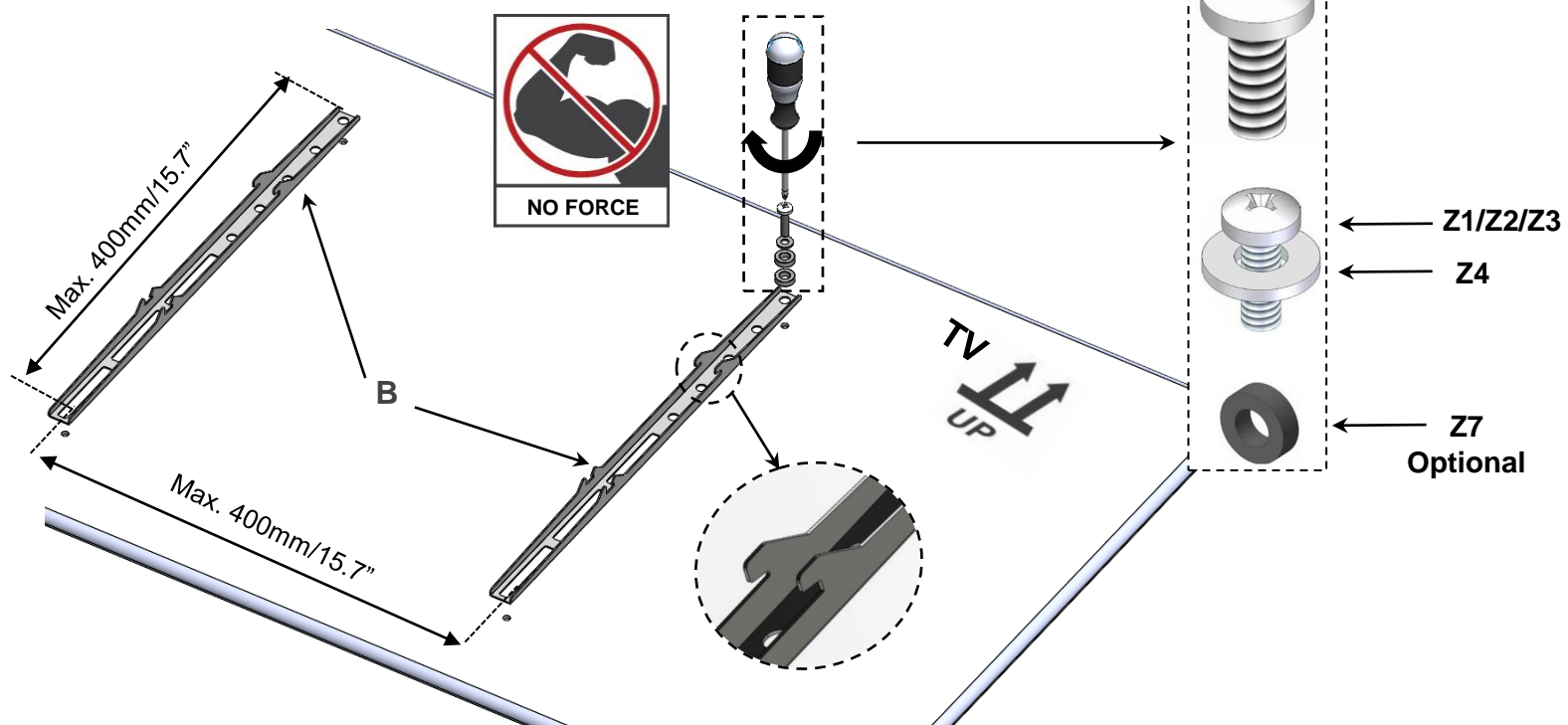

2

Page 4

For more positioning options



1b

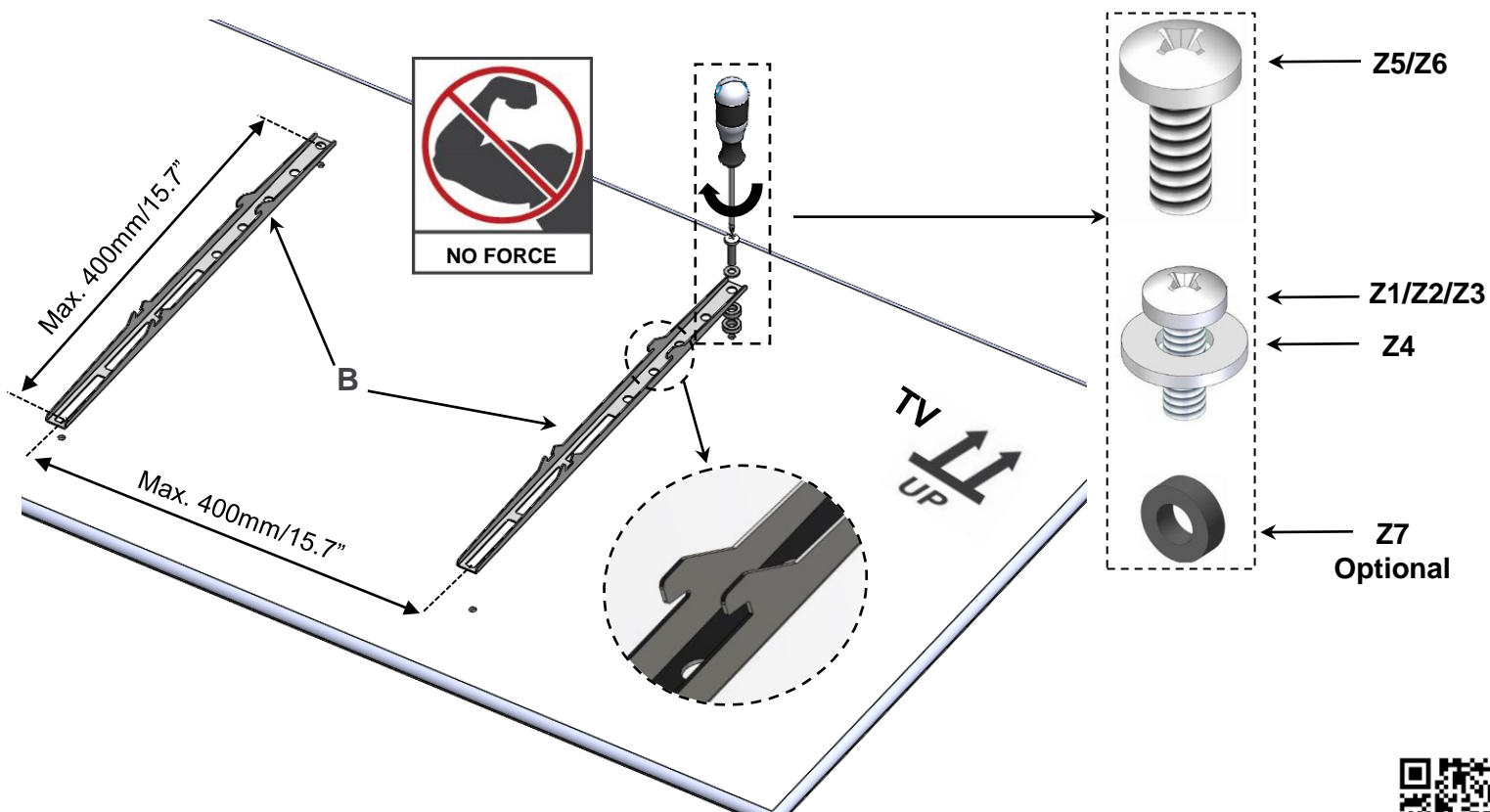

For more positioning options



2

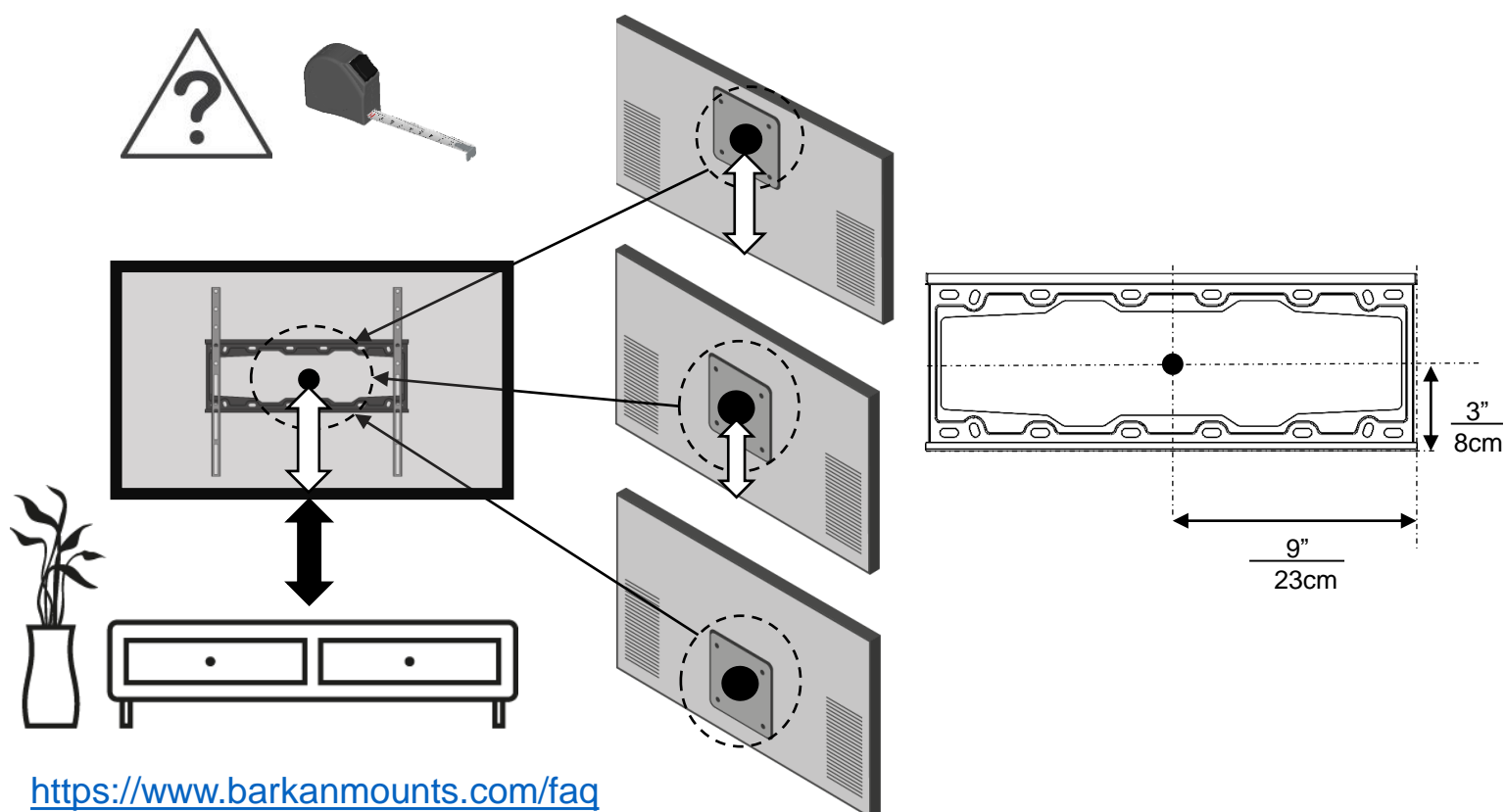

3

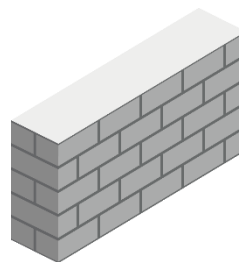
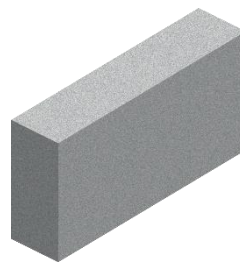
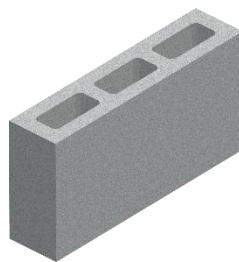

4

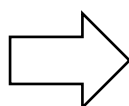
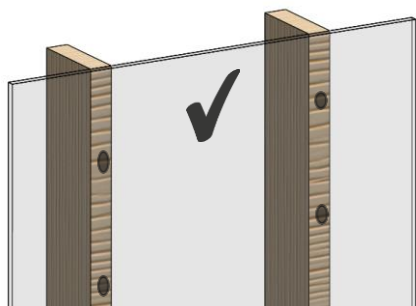
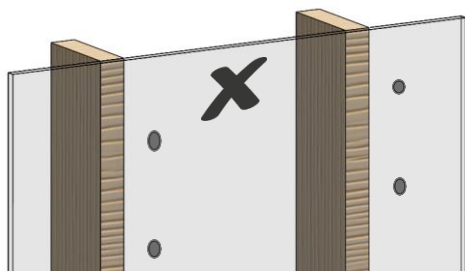
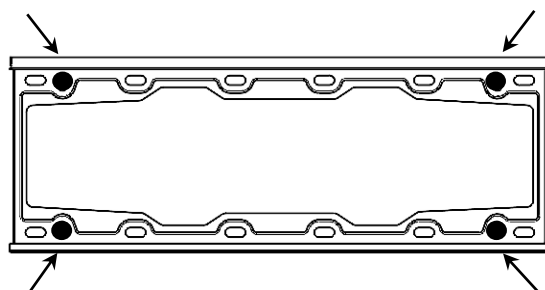
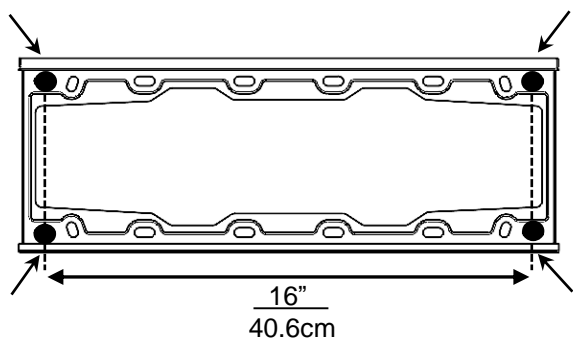
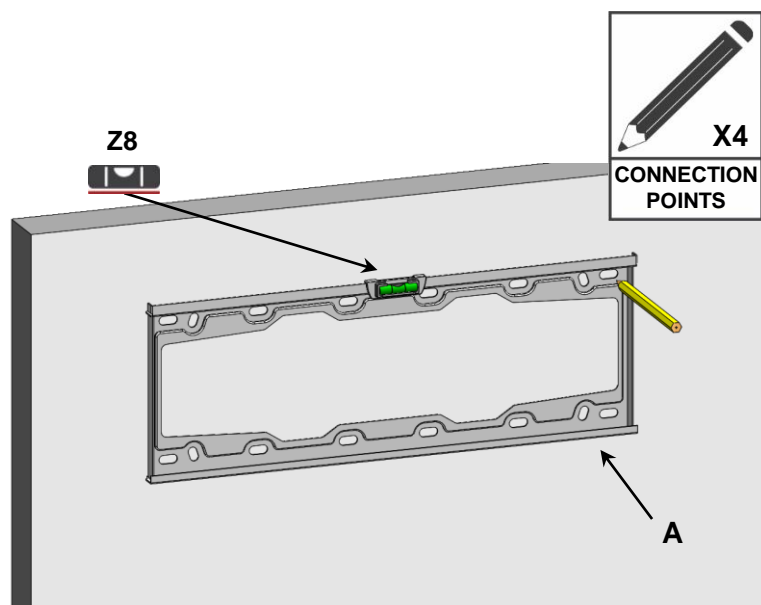
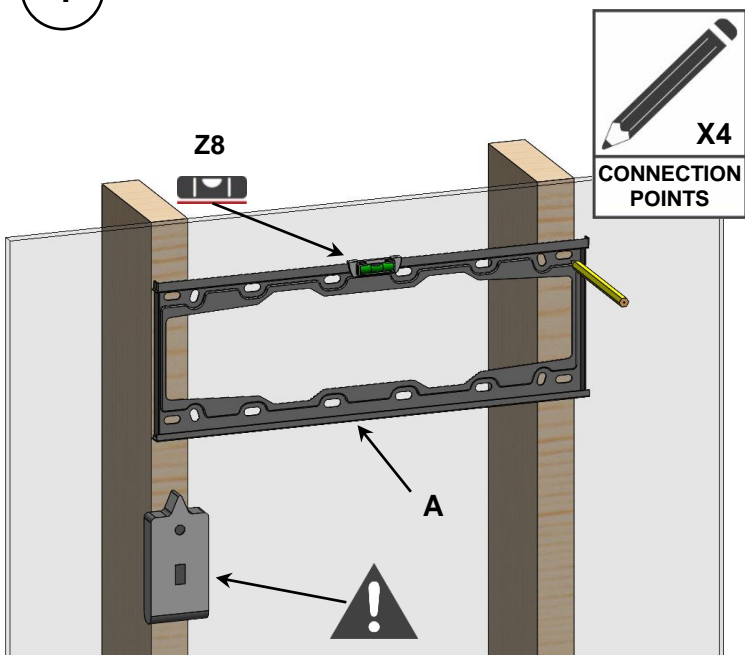

4a

Page 6

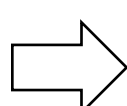

4b

Page 6

4a

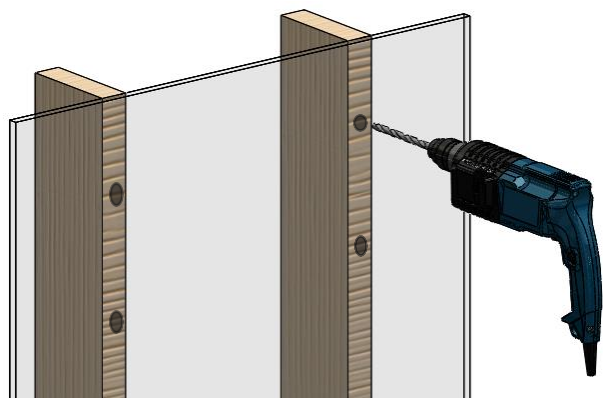
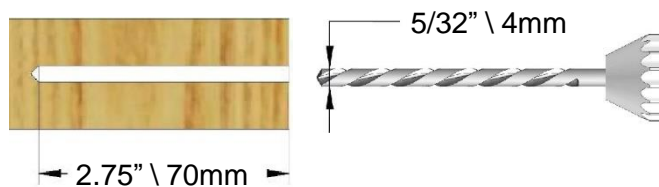

4b

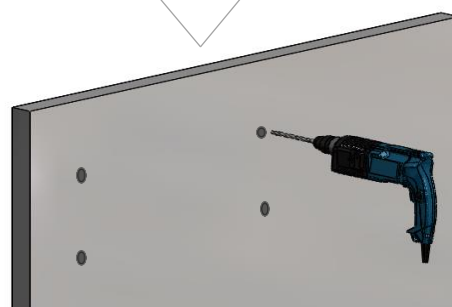
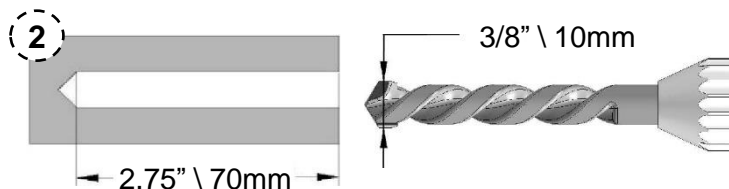
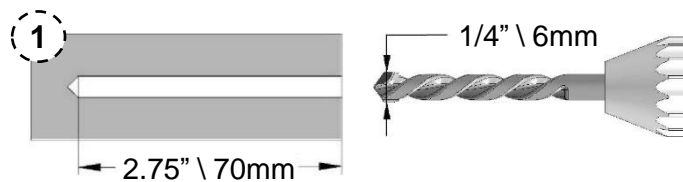

Z8

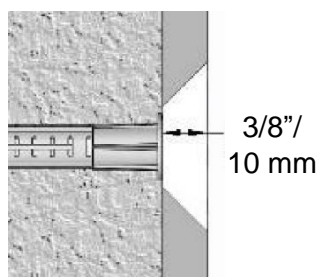
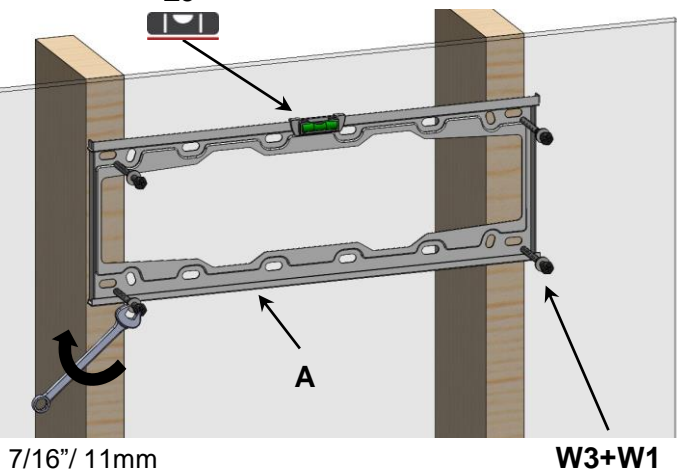

The anchor must be sunk at least 3/8"/10 mm into the plaster coating

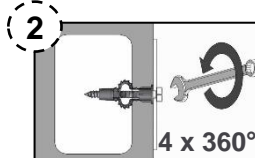
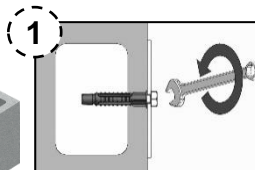
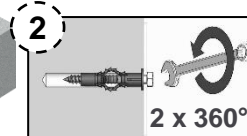
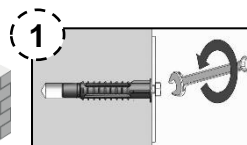
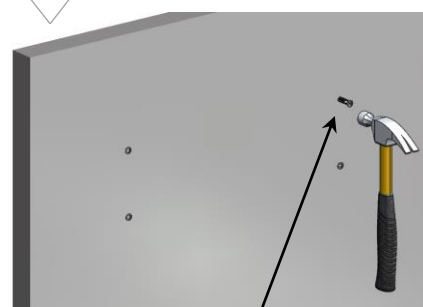

W3+W1

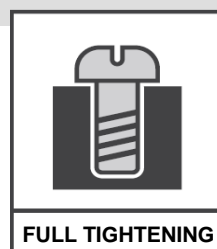
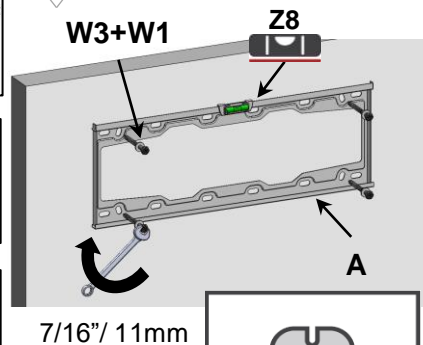

5

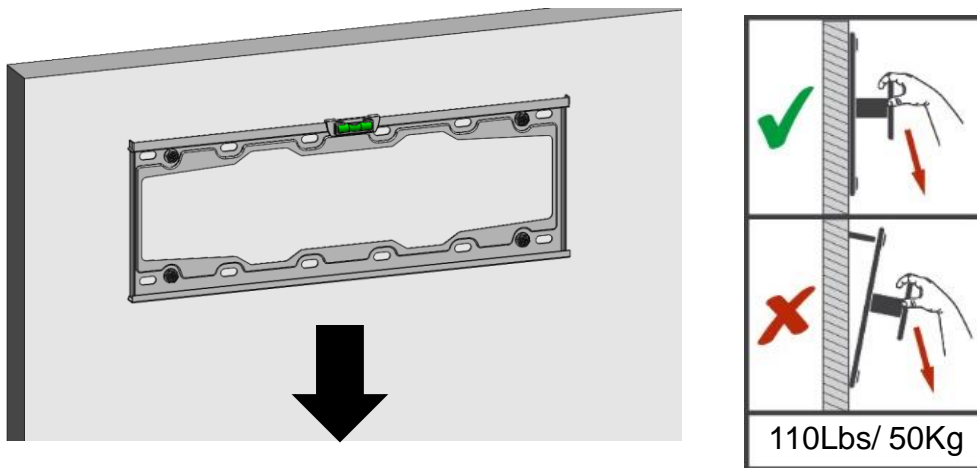

6

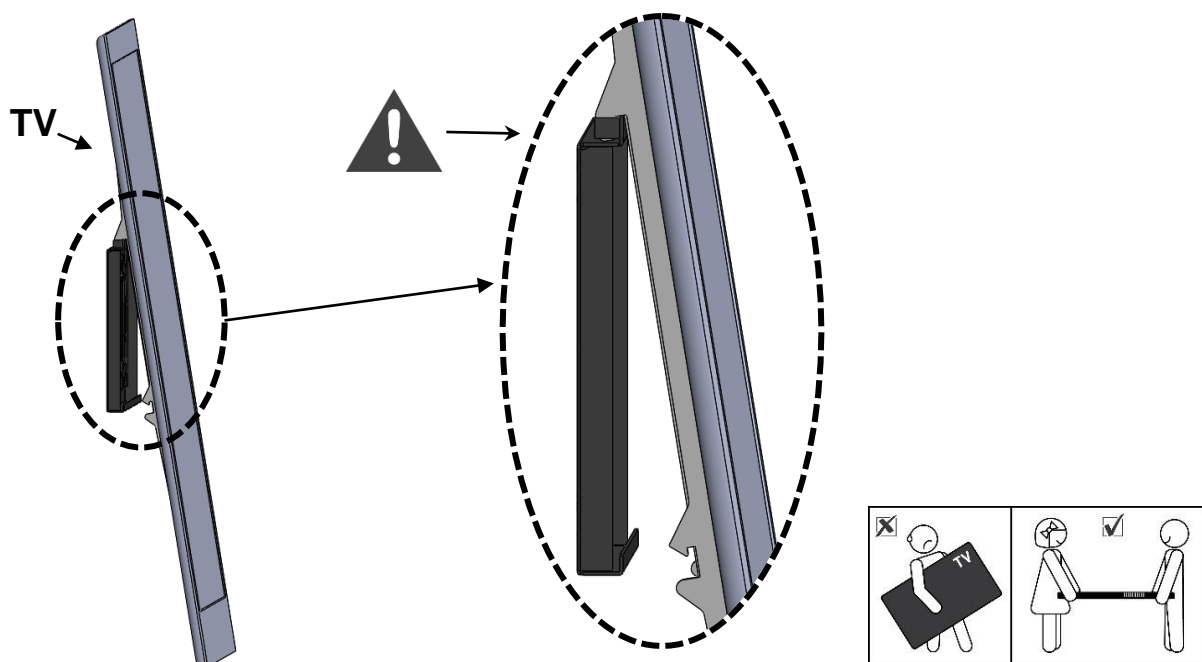

7

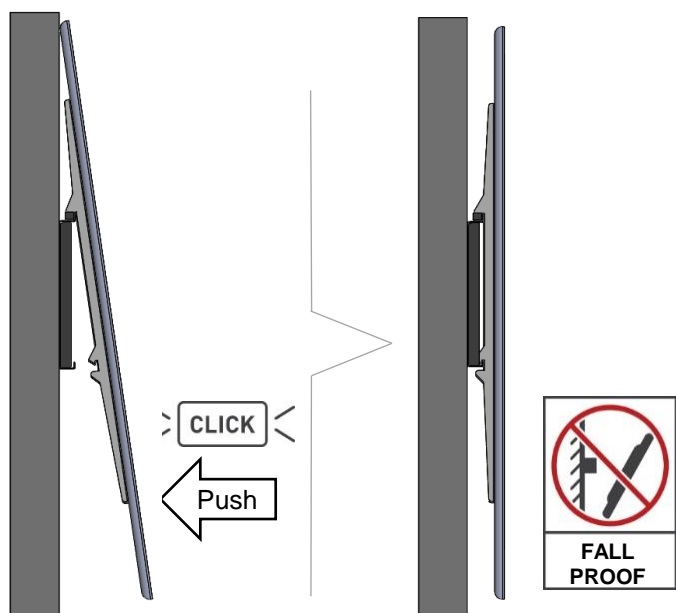

8

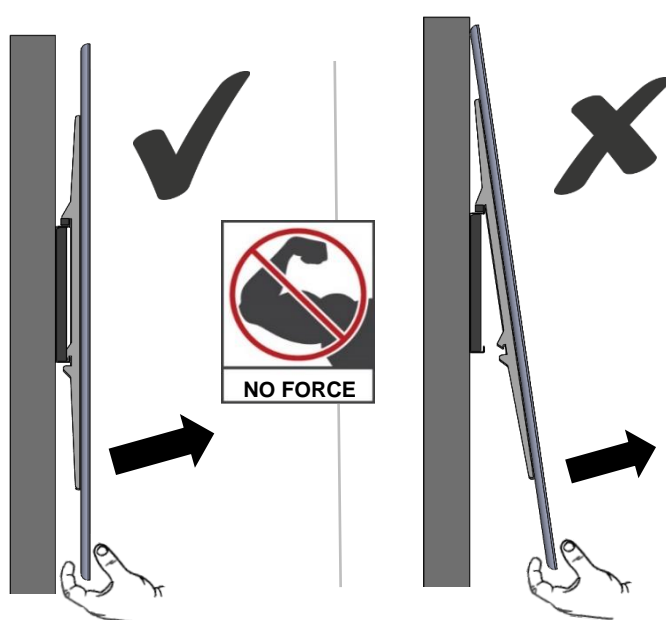

9

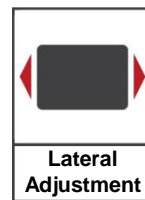
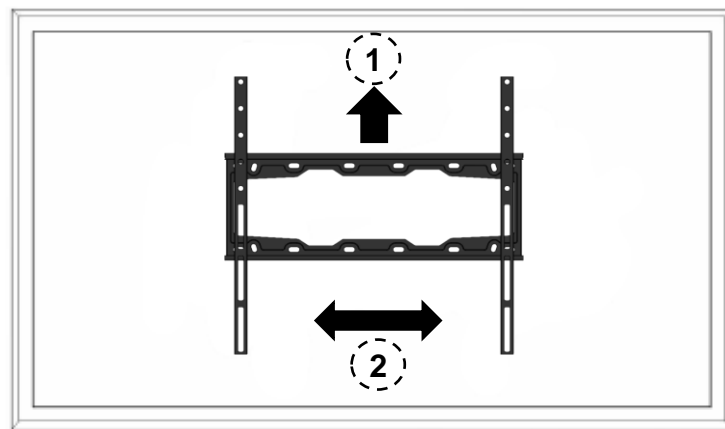
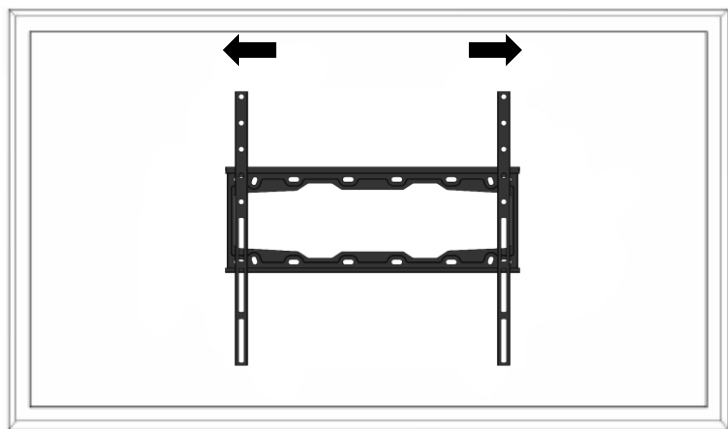

10

