

aiwa®

Japan est1951

HE-888BT

руководство  
пользователя

RU



ULTRA SLIM - HOME CINEMA  
SOUND BAR

aiwa®

Japan est1951

Follow us! aiwaEU



www.eu-aiwa.com

AIWA CO., LTD.  
Shinagawa-Ku  
TOKYO 141-0022, JAPAN

©AIWA EUROPE S.L.  
All Rights Reserved.

Printed in P.R.C.



HE-888BT

60W  
RMS  
POWER  
SOUND



UP TO  
10 METERS



HDMI - ARC  
+ CEC

DSP  
DIGITAL SIGNAL  
PROCESSOR



## 01. ACCESSORIES

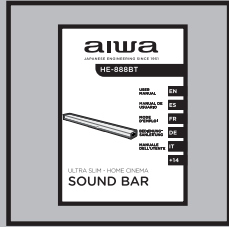
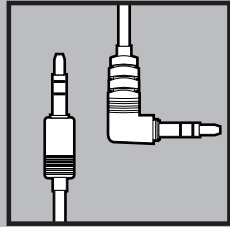
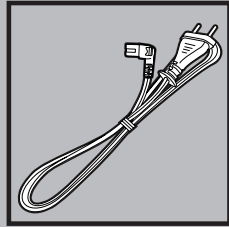
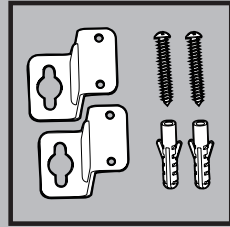
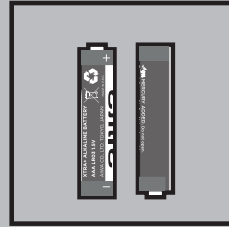
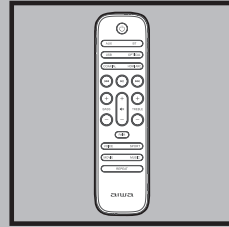
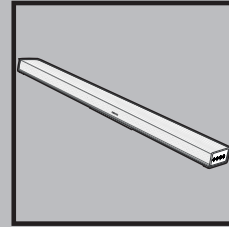

+ aiwa

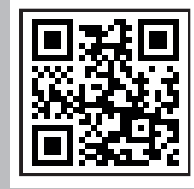

www.aiwa\_europe.com

## 02. OVERALL VIEW

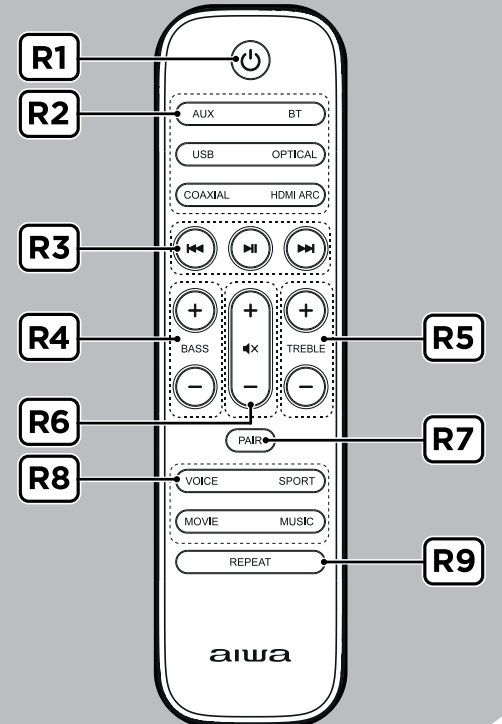
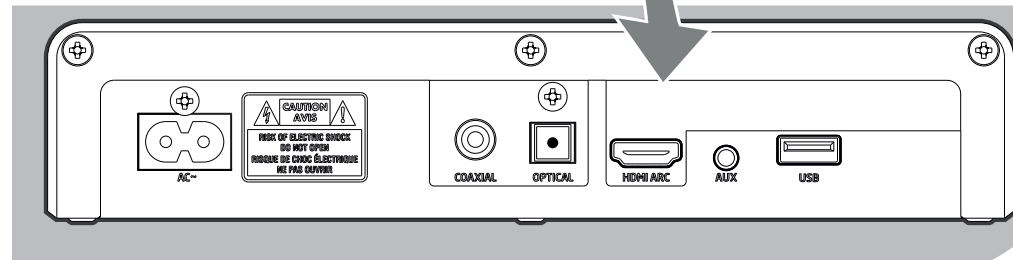
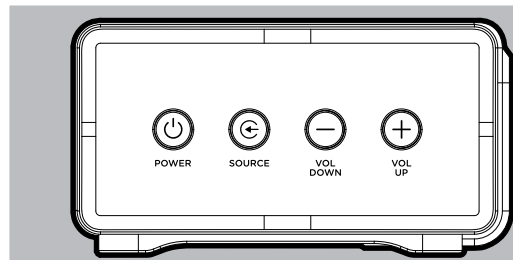
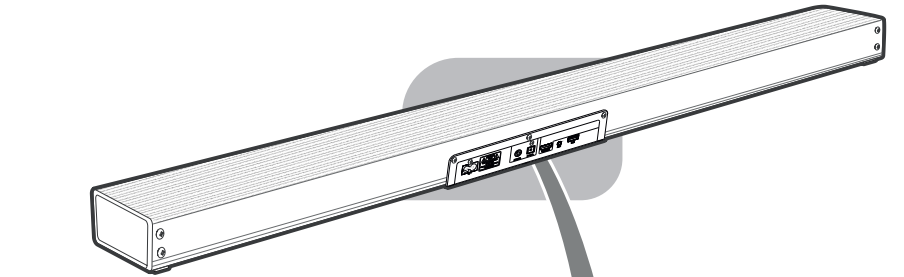
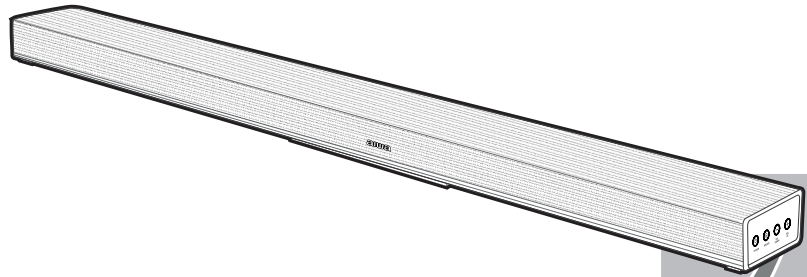
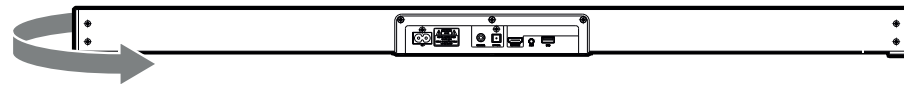

## 03. PLACEMENT AND MOUNTING

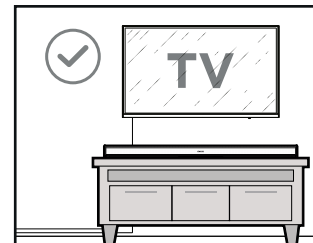
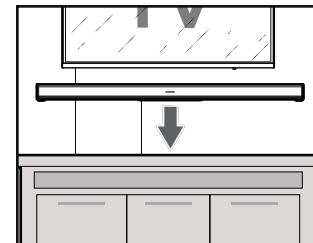
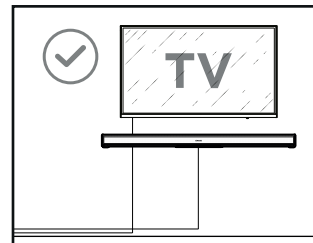
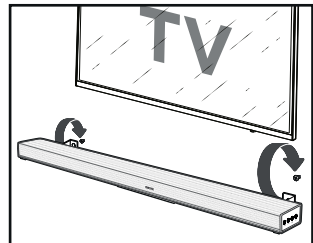
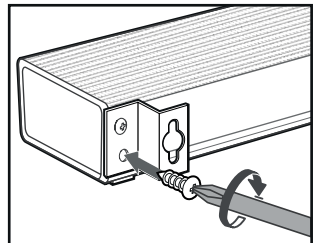
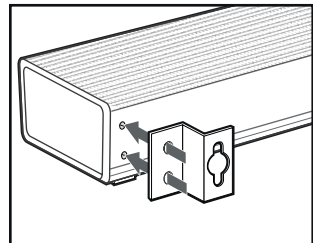
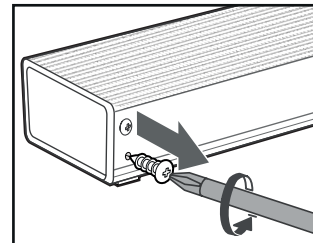
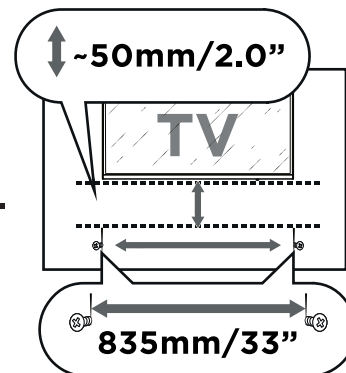

## 04. CONNECTION TO THE MAINS

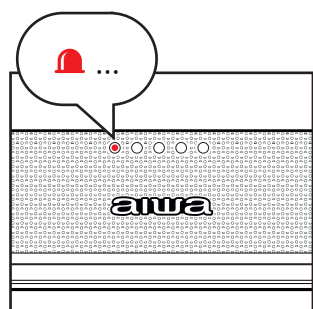
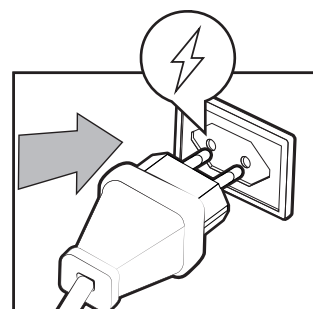
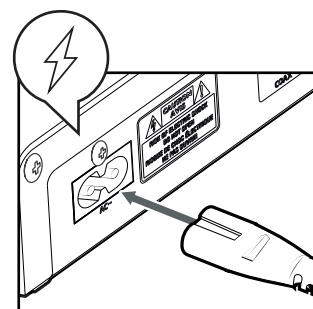

## 05. TURN ON

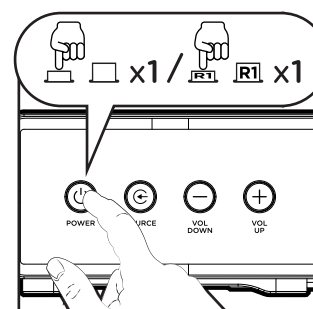

## 06. TURN OFF (STANDBY)

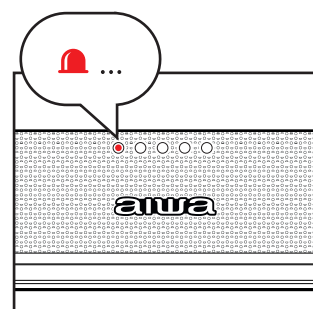
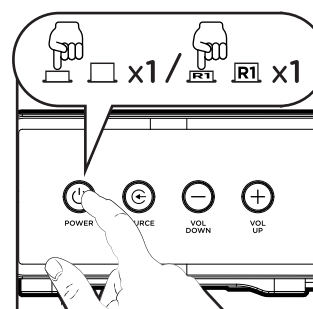

**07. VOLUME ADJUSTMENT** **08. MUTE** **09. TREBLE ADJUSTMENT** **10. BASS ADJUSTMENT** **11. EQUALIZER ADJUSTMENT**

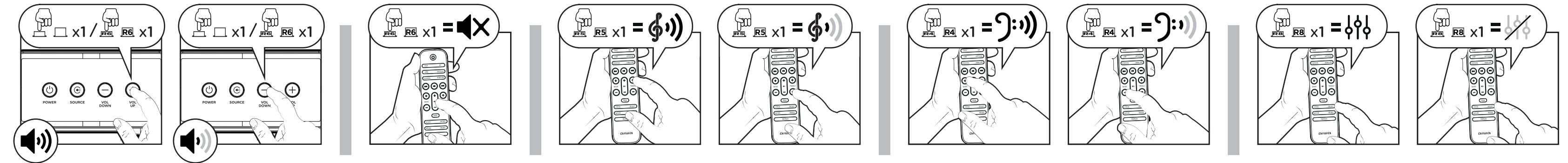

**12. BLUETOOTH FUNCTION & PAIRING SOLUTION** **13. USB MODE**

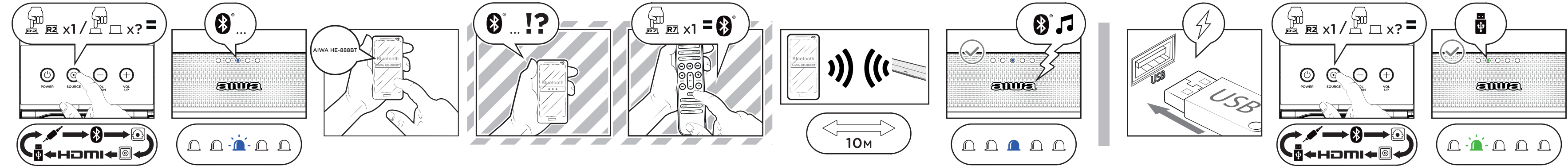

**14. MUSIC PLAYBACK FOR BLUETOOTH\* AND USB\*\* MODES** **15. REPEAT** **16. AUXILIARY INPUT MODE**

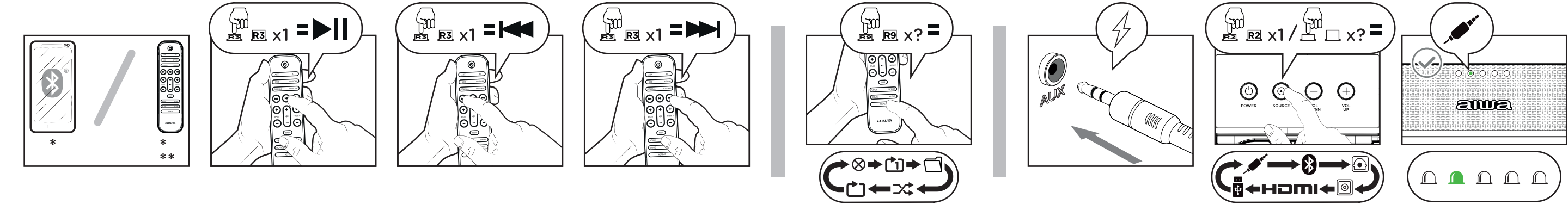

**17. COAXIAL INPUT MODE** **18. OPTICAL INPUT MODE** **19. HDMI INPUT MODE**

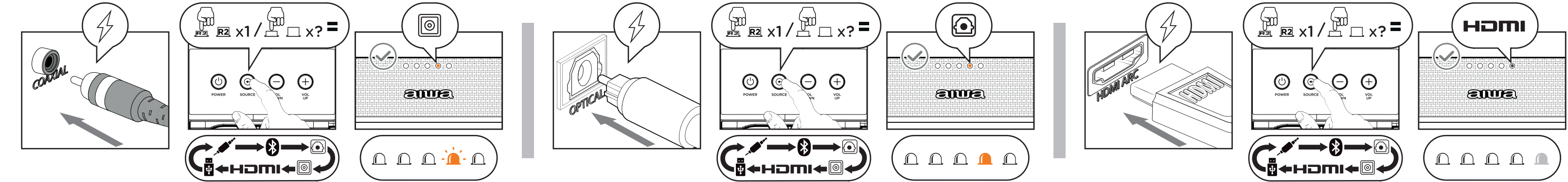

01. Аксессуары 02. Обзор 03. Монтажное положение 04. Питание 05. Включение 06. Выключение (Режим ожидания) 07. Громкость 08. Отключение звука 09. Регулировка высоких частот 10. Регулировка низких частот 11. Эквалайзер 12. Подключение по Bluetooth и решение 13. Режим USB 14. Воспроизведение музыки (BT\* и USB\*\* ) 15. Режим повтора 16. Режим вспомогательного разъема 17. Коаксиальный режим 18. Режим оптического входа 19. Режим HDMI.